

Vacant Land

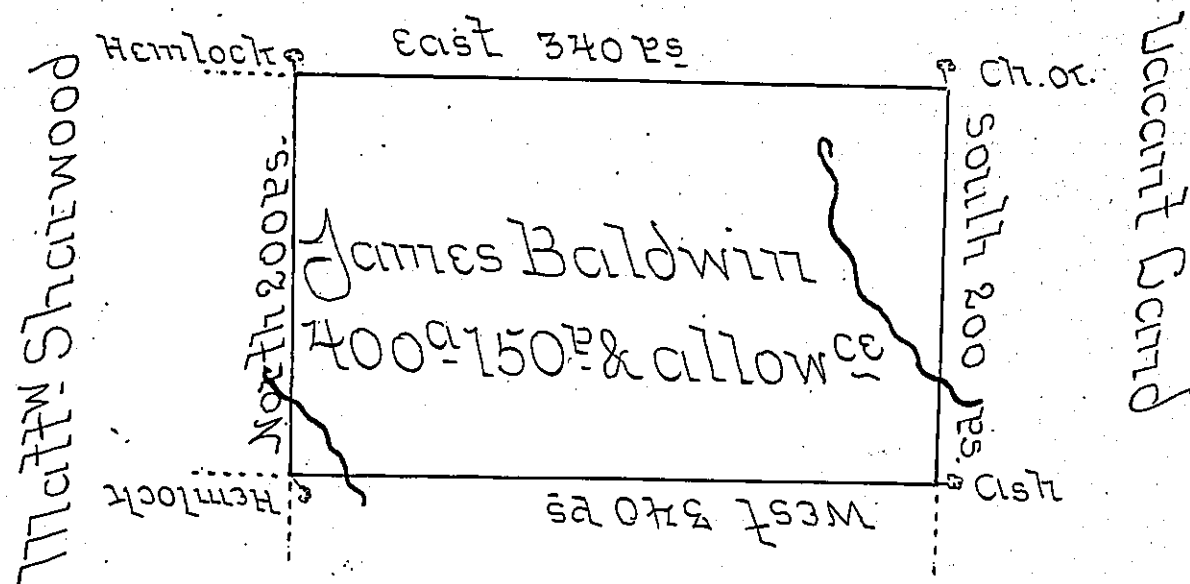

Thomas Baldwin

A Draught of a Tract of Land situate on the Waters of
 Little Sugar Creek in the County of Luzerne, Containing
 Four hundred Acres, 150 perches & Allow^{ce} of six Percent
 for Roads &c. Surveyed July 21st 1793 on a Warrant to
 James Baldwin dated the 13. Aug^t 1792

J. J. Wallis D.S.

To Hon^{ble} Brodhead Esq^r
 Survey General

IN TESTIMONY that the above is a copy of the original remaining on file in
 the Department of Internal Affairs of Pennsylvania, made
 conformably to an Act of Assembly approved the 16th day of
 February, 1833, I have hereunto set my Hand and caused
 the Seal of said Department to be affixed at Harrisburg,
 this second day of February 1907.

James P. Brown
 Secretary of Internal Affairs.